



MC-Montan Injekt

Consolidation of foundations,
stabilising and lifting of structural components

EXPERTISE
INJECTION



MC-Montan Injekt

Consolidating and strengthening of constructions

When it comes to stabilising and lifting of structures and building components, quality injection solutions are a must. MC-Montan Injekt resins are high-performance injection materials specifically formulated for consolidating and protecting industrial floors, carriageways and buildings. The options available offer a range of strengths, moduli of deformation and reactive expansion properties, with each product aligned to a certain set of technical requirements.

Stabilisation and lifting

Offering high strength values and defined deformation properties, **MC-Montan Injekt FF** and **MC-Montan Injekt CB** provide effective foundation support to load-bearing structural components. These resins reliably secure concrete slabs by not only thoroughly penetrating and consolidating the foundation soil around and under the structure but also effectively filling voids and cavities. The injection pressure can also be controlled to raise components to a certain specified level.

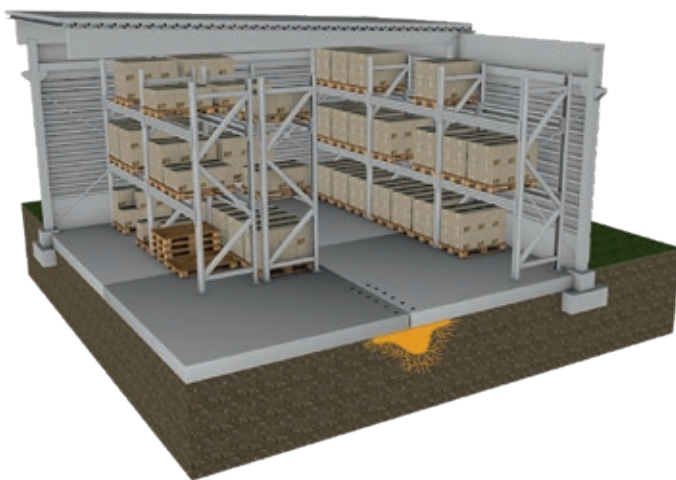

Floor slab consolidation in a storage depot

Load-bearing rigid foam

MC-Montan Injekt FF forms a high-density, load-bearing foam base. Irrespective of the properties of the injection medium, the result is a homogenous, waterproof course. **MC-Montan Injekt FF** is the first rigid foam system to successfully pass the current technical test requirements of Germany's Road and Transportation Research Association (FGSV).

Consolidating hybrid system

MC-Montan Injekt CB offers the combined benefits of reaction resin and mineral construction material. Regardless of the water content of the injection medium, it sets as a high-density resin monolith, enabling subsided components to be reliably and efficiently lifted and consolidated. **MC-Montan Injekt CB** is the first silicate system to successfully pass the current technical test requirements of Germany's Road and Transportation Research Association (FGSV).

Sound sustainability

Test certificates are available documenting the environmental compatibility of MC-Montan Injekt resins both during the injection process into soil and groundwater and in their cured condition. Preference is given in their formulation to environmentally acceptable, renewable raw materials.

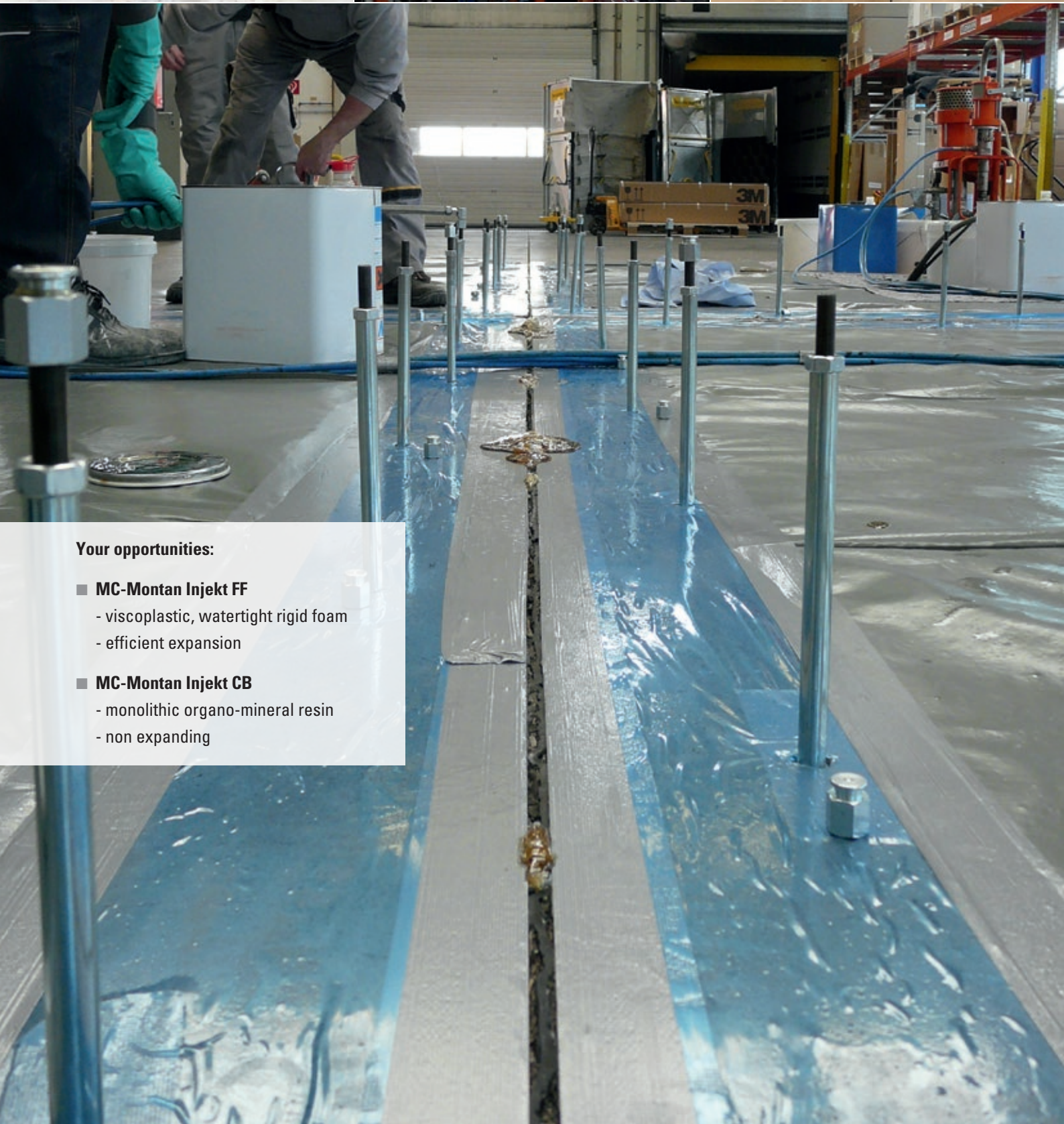

Your opportunities:

- **MC-Montan Injekt FF**
 - viscoplastic, watertight rigid foam
 - efficient expansion
- **MC-Montan Injekt CB**
 - monolithic organo-mineral resin
 - non expanding

MC-Montan Injekt

- Consolidation of foundation subsoil
- Stabilisation of industrial floors, carriageways and buildings
- Lifting of subsided structural components
- Waterproofing of constructions

MC-Bauchemie Müller GmbH & Co. KG
Infrastructure, Industry & Buildings
Am Kruppwald 1-8
46238 Bottrop, Germany

Phone: +49 2041 101-190
Fax: +49 2041 101-188

IN@mc-bauchemie.com
www.mc-bauchemie.com



BE SURE. BUILD SURE.

Contact details

